

SMA Straight Bulkhead Receptacle Jack
Solder End

SMA2FB50-1510B/91

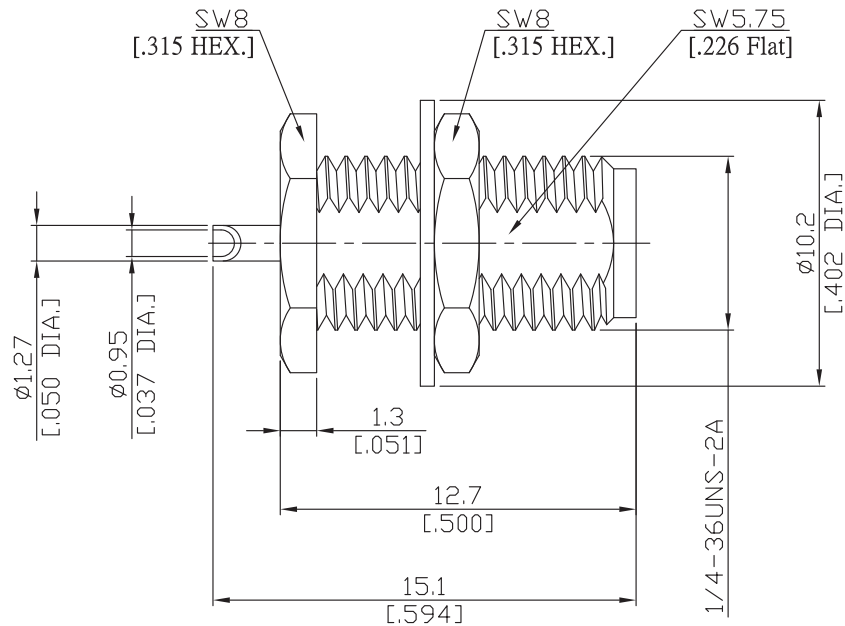

All dimensions are in mm [inch]
Tolerances according to DIN ISO 2768-mH

Interface

According to IEC 60169-15; MIL-C-39012; MIL-STD-348A/310

Electrical Data

Impedance: 50 Ω
 Frequency: DC to 18 GHz
 VSWR (Return Loss): ≤ 1.25 (≥ 19.08 dB)
 Insertion Loss: $\leq 0.05 \times \sqrt{F}$ (GHz) dB

Mechanical Data

Coupling mechanisms: Screw-lock
 Weight: 0.0024 kg

Environmental Data

Temperature range: -65°C to +165°C
 RoHS: compliant

Material And Plating

Piece Parts	Material	Plating
Centre contact	Beryllium Copper	Gold plating(Nickel underplated)
Body	Brass	Gold plating(Nickel underplated)
Insulator	PTFE	
Fastening nut	Brass	Gold plating(Nickel underplated)
Washer	Brass	Gold plating(Nickel underplated)

Packing

Single or 100

Related Document

Mounting Dimension MD19