

## N Right Angle Cable Plug

### N1C59-G058A/133

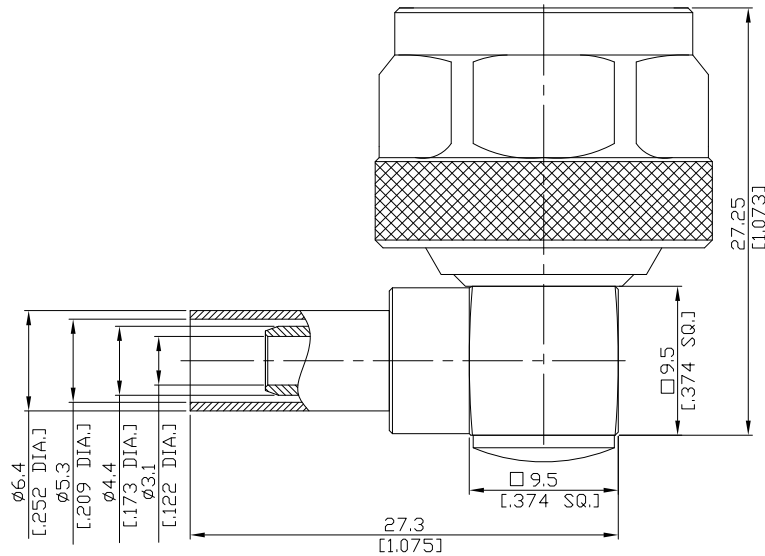

All dimensions are in mm [inch]

Tolerances according to DIN ISO 2768-mH

#### Interface

According to MIL-C-39012; MIL-STD-348A/304

#### Electrical Data

Impedance: 50  $\Omega$   
 Frequency: DC to 18 GHz  
 VSWR (Return Loss):  $\leq 1.22$  ( $\geq 20$ dB), DC to 11GHz  
 Insertion Loss:  $\leq 0.05$  dB

- Limitations are possible due to the used cable type -

#### Mechanical Data

Coupling mechanisms: Screw-lock  
 Centre contact: Soldered  
 Cable entry: Crimped

#### Environmental Data

Temperature range: -65°C to +165°C  
 RoHS: compliant

#### Material And Plating

| Connector parts | Material        | Plating                          |
|-----------------|-----------------|----------------------------------|
| Centre contact  | Brass           | Gold plating(Nickel underplated) |
| Body            | Brass           | Nickel                           |
| Insulator       | PTFE            |                                  |
| Gasket          | Silicone Rubber |                                  |
| Coupling nut    | Brass           | Nickel                           |
| Crimp ferrules  | Brass           | Nickel                           |

#### Suitable Cables

RG 58, RG 58A, RG 58C, RG 141, RG 303, BELDEN 7806A, BELDEN 9907, LMR 195

#### Packing

Single or 100