

SMA Straight Panel Receptacle Plug (Coaxial End)

SMA1GFA50-3050A/111

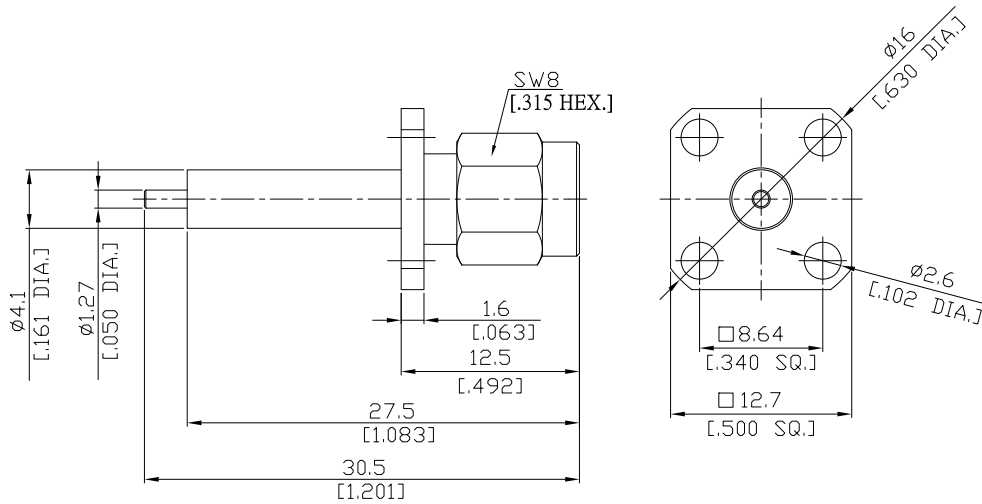

All dimensions are in mm [inch]

Tolerances according to DIN ISO 2768-mH

Interface
According to MIL-C-39012; MIL-STD-348A/310

Electrical Data

- Impedance: 50 Ω
- Frequency: DC to 18 GHz
- VSWR (Return Loss): ≤ 1.25 (≥ 19.08 dB)
- Insertion Loss: $\leq 0.05 \times \sqrt{F}$ (GHz) dB

Mechanical Data

- Coupling mechanisms: Screw-lock
- Weight: 0.0047 kg

Environmental Data

- Temperature range: -65°C to +165°C
- RoHS: compliant

Material And Plating

Piece Parts	Material	Plating
Centre contact	Brass	Gold plating(Nickel underplated)
Body	Brass	Gold plating(Nickel underplated)
Insulator	PTFE	
Gasket	Silicone Rubber	
Coupling nut	Brass	Gold plating(Nickel underplated)

Packing
Single or 100

Related Document
Mounting Dimension MD71

The facts and figures herein are carefully compiled to the best of our knowledge, but they are intended for general informational purposes only. In the effort to improve our products, we reserve the right to make changes judged to be necessary.

Rev.: Rosnol RF/Microwave Technology
www.rosnol.com ; info@rosnol.com
Date: 19/11/10
Phone:+886-3-463-5095
Fax:+886-3-463-5952

Page

1/1