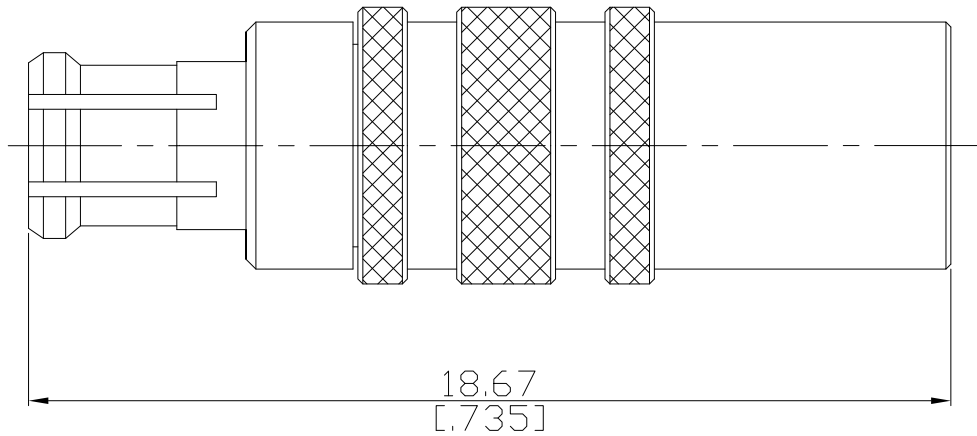

Adaptor plug/jack
MCX plug (male) / MCX jack (female)
AD-M1M25A/99-91

All dimensions are in mm [inch]

Tolerances according to DIN ISO 2768-mH

Interface

According to IEC 61169-36

Electrical Data

 Impedance 50 Ω
 Frequency DC to 6 GHz
 VSWR (Return Loss) ≤ 1.22 (≥ 20 dB)
 Insertion Loss $\leq 0.1 \times \sqrt{F}$ (GHz) dB

Mechanical Data

 Coupling mechanisms Snap-lock
 Weight 0.0016 kg

Environmental Data

 Temperature range -55°C to +155°C
 RoHS compliant

Material And Plating

Piece Parts (MCX)	Material	Plating
Centre contact	Beryllium Copper	Gold plating(Nickel underplated)
Body	Beryllium Copper	Gold plating(Nickel underplated)
Insulator	PTFE	

Piece Parts (MCX)	Material	Plating
Centre contact	Beryllium Copper	Gold plating(Nickel underplated)
Body	Brass	Gold plating(Nickel underplated)
Insulator	PTFE	

Packing

Single or 100