

1

2

3

4

5

6



7

Material

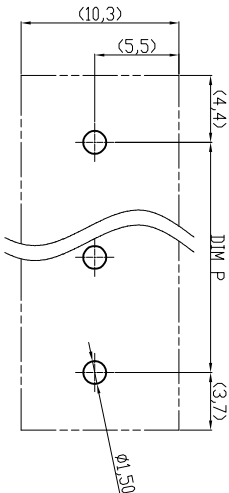
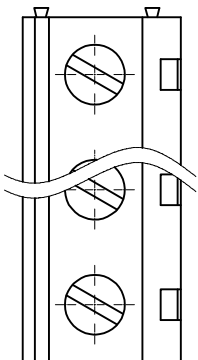
- ① Terminal housing: Thermoplastic (UL94V-0), GREEN
- ② Clamp: Brass, Ni plated
- ③ Wire guard solder pin: Brass, Tin plated
- ④ Terminal screw: Steel Zinc plating "r" slot type



RECOMMENDER PCB LAYOUT

Electrical	UL	VDE
Voltage rating:	300V	450V
Current rating:	10A	10A
Wire range:		0.34-4.0mm ²
Solid wire(AWG):	12-22	
Stranded wire(AWG):	12-22	
Torque(Lb-In):	3.5Lb-In	0.4 Nm
Screw:	M2.5	
Wire strip length:	6-7mm	
Withstanding Voltage:	1.6KV	2.5KV
Operating temperature:	-40°C to +115°C	
Soldering temperature:	250°C±10°C/5 Sec	
Safety Approval:		

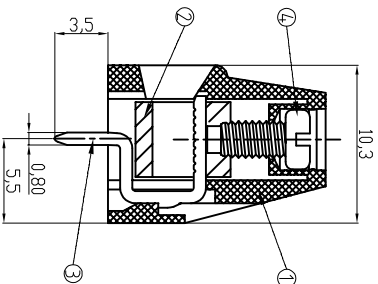
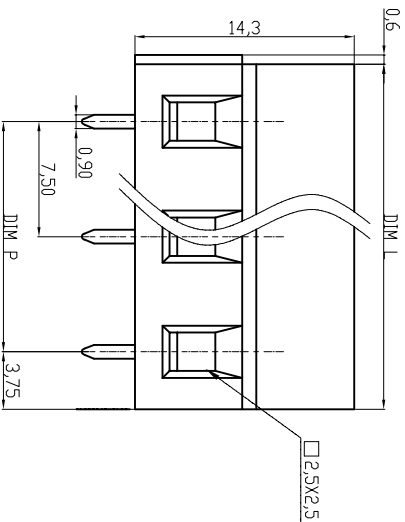

DIMENSION

L	Nx7.5
P	(N-1)x7.5

N=Number of poles

Poles	Tolerance	
	DIM L	DIM P
2p-4p	±0.20	±0.20
5p-8p	±0.25	±0.25
9p-12p	±0.35	±0.35

Customer-No.

ASSMANN WSW-No.
A-TB750-T1XX

Drawing-No.

ASS 4105 CO rev01

Replace

Sheet

Scale	1:1								
TOLERANCE									
X.	±0.50				Drawn	19.04.2010	Alex		
X.X	±0.30				Approved	19.04.2016	Winnie		
X.XX	±0.10								
DIM	TOL								
X.°	±1°								
Angle									
TOL									
Id.									
Modification									
Date									
Name									



File No.: E349947

RoHS compliant

1

2

3

4

5

6

7

1 2 3 4 5 6 7

H G F E D C B A