



Image for illustrative purpose only

Summary

[Request a quote](#)

[Catalog](#)

Number of contacts Low Voltage	65
Wire Size/AWG	32 - 28
Socket / Receptacle	Socket / Receptacle - Fixed Panel Front Mounted
Locking system	Push-pull
Jacket cable outside diameter [mm]	2.00 - 9.20 mm
Size	1R
Suggested matching part	FGG.1R.365.GLC92

https://www.lemo.com/int_en/ebg-1r-365-glm.html

LEMO products and services are provided "as is". LEMO makes no warranties or representations with regard to LEMO product & services or use of them, express, implied or statutory, including for accuracy, completeness, or security. The user is fully responsible for his products and applications using LEMO components.

Technical details

Electrical Configuration

Contact Termination Low voltage	Crimp
Insert configuration value	1R.365 - 65 low voltage
Insulator	L: PEEK (UL 94 / V-0/1.5)
Rated current	0.5 A
Test voltage (kV rms) Contact-contact	0.6
Contact Type	Crimp
Contact Dia.	0.5
Number of contacts Low Voltage	65
Wire Size/AWG	32 - 28

Form & Material

Shell style / Model id	EBG - Fixed receptacle, key (G) or key (A) with visible shell
Socket / Receptacle	Fixed Panel Front Mounted
Housing material	Crastin® PBT (Polybutylene terephthalate), gray
Locking system	Push-pull
Keying	3 keys (alpha=50,beta=30, plug: male contacts, receptacle: female contacts)
Weight	16.86 g

Environment

Environmental sealing (IP rating)	IP50
-----------------------------------	------

Cable fixation

Jacket cable outside diameter [mm]	2.00 - 9.20 mm
------------------------------------	----------------

Drawings

https://www.lemo.com/int_en/ebg-1r-365-glm.html

LEMO products and services are provided "as is". LEMO makes no warranties or representations with regard to LEMO product & services or use of them, express, implied or statutory, including for accuracy, completeness, or security. The user is fully responsible for his products and applications using LEMO components.

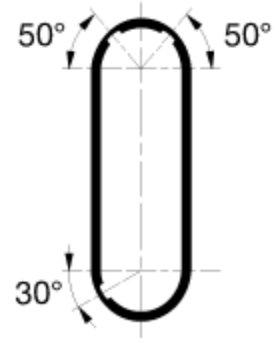
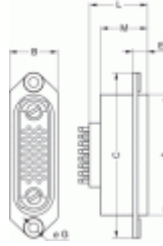

Dimensions

	A	B	C	E	G	L	M
mm.	37	15	51	4.5	3.2	19.5	14.5
in.	1.46	0.59	2.01	0.18	0.13	0.77	0.57

Recommended By Lemo

Accessories

Replacement contact [EGG.00.654.ZZM](#)

Tools

Positionner [DCE.91.051.BVM](#)

Extraction tool [DCC.05.02B.LAG](#)

Crimp tool [DPC.91.701.V](#)

https://www.lemo.com/int_en/ebg-1r-365-glm.html

LEMO products and services are provided "as is". LEMO makes no warranties or representations with regard to LEMO product & services or use of them, express, implied or statutory, including for accuracy, completeness, or security. The user is fully responsible for his products and applications using LEMO components.