

| REVISIONS | | | | | |
|-----------|--------|-----------------------------|-----------|--------|-------|
| REV | ECO | DESCRIPTION | DATE | BY | APPR |
| A3 | - | RELEASE NEW DWG FORMAT | 30/JUN/13 | DRP | - |
| A4 | C0855S | CONTACT INFORMATION UPDATED | 03/MAY/18 | ROOKIE | TOMMY |
| A5 | C1070S | UPDATE DRAWING | 02/JUL/19 | JOE | TOMMY |
| B1 | C1298S | UPDATE PLATING | 14/SEP/20 | SULLEN | TOMMY |
| B2 | - | CORRECTED PLATING ZONES | 12/APR/24 | CHRIS | TODD |

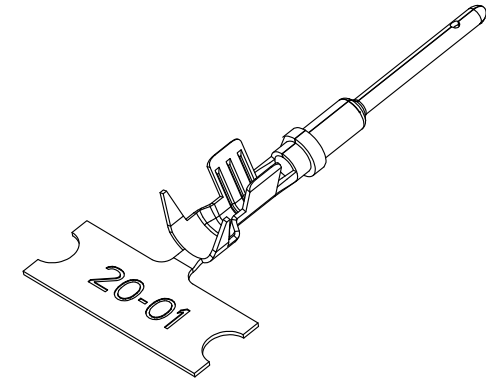

NOTES: UNLESS OTHERWISE SPECIFIED

- MATERIAL: COPPER ALLOY
- PLATING: SEE PART NUMBER CHART
- CONTACT SIZE: 20
- SPECIFICATIONS:
 - CURRENT RATING: 7.5 AMPS
 - CONTACT MILLIVOLT DROP: 100 MILLIVOLT DROP @ 7.5 AMP TEST CURRENT.
 - RoHS COMPLIANT
- RECOMMENDED WIRE RANGE: 16 - 22 AWG (1.5 - 0.35MM²)
RECOMMENDED INSUL O.D.: 1.91 - 3.15MM (0.075 - 0.125INCH)
- PACKAGE: 4000 PCS/REEL
- AVAILABLE APPLICATORS: MFX-3974-K OR MFX-3974-G
- ALL DIMENSIONS ARE FOR REFERENCE USE ONLY

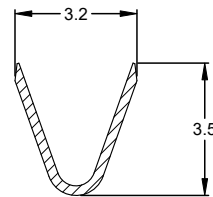

SECTION A-A

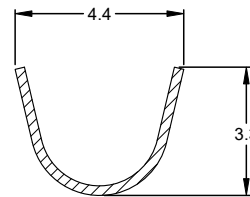

SECTION B-B

| PART NUMBER CHART | | |
|-------------------|--------------|---|
| PLATING | PART NUMBER | PLATING DESCRIPTION |
| NICKEL | AT60-20-0122 | SELECTIVE TIN OVER NICKEL OVERALL IN Δ ZONE |
| GOLD | AT60-20-0144 | SELECTIVE GOLD FLASH OVER NICKEL OVERALL IN Δ ZONE OR ENTIRE CONTACT |
| TIN | AT60-20-0177 | TIN OVER NICKEL OVERALL |

| SEE PART NUMBER CHART | | REF: 1060-20-0144, 1060-20-0122, 1060-20-0177 | |
|---|-------------|--|---|
| QUANTITY | PART NUMBER | DESCRIPTION | ITEM |
| MATERIALS LIST | | | |
| UNLESS OTHERWISE SPECIFIED: 1) All dimensions are in metric (mm). 2) Tolerances are as follows: 1 PL DEC ±0.30 2 PL DEC ±0.15 3 PL DEC ±0.08 3) Note reference = Δ | | SIGNATURES DRAWN: SULLEN ZHANG CHECKED: ORION LI ENGINEER: APPROVAL: TOMMY XIE | DATE 14/SEP/20 15/SEP/20 16/SEP/20 |
| MATERIAL SPECIFICATIONS: | | Sine Systems - www.amphenol-sine.com 44724 Morley Drive Clinton Township, MI 48036 | |
| PROCESS SPECIFICATIONS: | | THIS DRAWING IS SUPPLIED FOR INFORMATION ONLY. DESIGN FEATURES, SPECIFICATIONS AND PERFORMANCE DATA SHOWN HEREON ARE THE PROPERTY OF THE AMPHENOL CORPORATION. NO RIGHTS OF REPRODUCTION ARE IMPLIED. ALL DIMENSIONS ARE SUBJECT TO NORMAL MANUFACTURING VARIATIONS. | |
| NEXT ASSY: | | SIZE B C- | TYPE SCALE: NONE |
| | | DWG NO: AT60-20-01XX | REVISION B2 |
| | | SHEET 1 OF 1 | |

TITLE: CONTACT PIN, STAMPED, SIZE 20, 16-22 AWG, A SERIES
DWG NO: AT60-20-01XX
REV: B2
SH: 1
OF: 1