

*Image for illustrative purpose only*

## Summary

[Request a quote](#)

[Catalog](#)

Number of contacts Low Voltage	8
Gender	Standard
Locking system	Push-pull
Size	2B
Suggested matching part	<a href="#">FGG.2B.308.CLAD72</a>
Series	B - Indoor keyed

[https://www.lemo.com/int\\_en/solutions/originals/b-indoor-keyed/sjg-2b-308-clap.html](https://www.lemo.com/int_en/solutions/originals/b-indoor-keyed/sjg-2b-308-clap.html)

LEMO products and services are provided "as is". LEMO makes no warranties or representations with regard to LEMO product & services or use of them, express, implied or statutory, including for accuracy, completeness, or security. The user is fully responsible for his products and applications using LEMO components.

# Technical details

## Electrical Configuration

Insert configuration value	2B.308 - 8 Low Voltage
Insulator	L: PEEK (UL 94 / V-0/1.5)
Rated current	10 A
Vtest (contact-contact)	1500 V (AC), 2120 V (DC)
Vtest (contact-shell)	1250 V (AC), 1770 V (DC)
Contact Type	Solder
Contact Dia.	0.9 mm (0.04in)
Number of contacts Low Voltage	8
Gender	Standard

## Form & Material

Shell style / Model id	SJG - Fixed coupler, nut fixing, keys (G, A, B, J, K, L) at the flange end and keys (G, A, B, J, K, L) at the other end, watertight or vacuum-tight
Housing material	Brass (chrome plated [SAE AMS 2460]) shell and collet nut, nickel plated [SAE AMS QQ N 290] brass latch sleeve and mid pieces
Locking system	Push-pull
Keying	Front side: 2 keys (alpha=37.5, male) , Other side: 1 key (alpha=0, female)
Colour	Grey
Variant	Watertight unmated (connector to device)
Weight	39.9 g

[https://www.lemo.com/int\\_en/solutions/originals/b-indoor-keyed/sjg-2b-308-clap.html](https://www.lemo.com/int_en/solutions/originals/b-indoor-keyed/sjg-2b-308-clap.html)

LEMO products and services are provided "as is". LEMO makes no warranties or representations with regard to LEMO product & services or use of them, express, implied or statutory, including for accuracy, completeness, or security. The user is fully responsible for his products and applications using LEMO components.

## Environment

Technical domain	Audio Video, Energy and Industrial, Medical, Semiconductor, Specialties and Other, Test and Measurement, Transportation, Aerospace and UAV
Environmental sealing (IP rating)	IP68
Endurance	5000 mating cycles
Temperature range	-20°C / +80°C
Climatical Category	20/80/21
Humidity (max)	<=95% [at 60 deg C /140 F]
Shielding (min)	75 dB (10 MHz)
Shielding (min)	40 dB (1 GHz)
Shock Resistance	100 g [ 6 ms]
Vibration	15 g [10 Hz - 2000 Hz]
Pressure	40 bars
Salt Spray Corrosion	>1000 hr

## Drawings

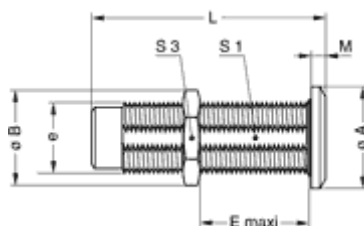

## Dimensions

	A	B	e	E	L	M	S1	S3
mm.	20	21.8	M16x1.0	25	44	4	15	19
in.	0.79	0.86		0.98	1.73	0.16	0.59	0.75

## Recommended By Lemo

### Accessories

Compatible cap [BRE.2S.200.NAS](#)

[https://www.lemo.com/int\\_en/solutions/originals/b-indoor-keyed/sjg-2b-308-clap.html](https://www.lemo.com/int_en/solutions/originals/b-indoor-keyed/sjg-2b-308-clap.html)

LEMO products and services are provided "as is". LEMO makes no warranties or representations with regard to LEMO product & services or use of them, express, implied or statutory, including for accuracy, completeness, or security. The user is fully responsible for his products and applications using LEMO components.