

## Summary

[Request a quote](#)

[Catalog](#)

Number of contacts Low Voltage	7
Gender	Reverse Gender
Locking system	Push-pull
Size	0B
Series	B - Indoor keyed

## Technical details

### Electrical Configuration

Insert configuration value	0B.307 - 7 Low Voltage
Insulator	L: PEEK (UL 94 / V-0/1.5)
Rated current	2.5 Amps
Vtest (contact-contact)	800 V (AC), 1130 V (DC)
Vtest (contact-shell)	700 V (AC), 990 V (DC)
Contact Type	Solder
Contact Dia.	0.5 mm (0.02in)
Number of contacts Low Voltage	7
Gender	Reverse Gender

[https://www.lemo.com/int\\_en/solutions/originals/b-indoor-keyed/sgj-0b-307-cllpv.html](https://www.lemo.com/int_en/solutions/originals/b-indoor-keyed/sgj-0b-307-cllpv.html)

LEMO products and services are provided "as is". LEMO makes no warranties or representations with regard to LEMO product & services or use of them, express, implied or statutory, including for accuracy, completeness, or security. The user is fully responsible for his products and applications using LEMO components.

## Form & Material

Shell style / Model id	SGJ - Fixed coupler, nut fixing, keys (G, A, B, J, K, L) at the flange end and keys (G, A, B, J, K, L) at the other end, watertight or vacuum-tight
Housing material	Brass (chrome plated [SAE AMS 2460]) shell and collet nut, nickel plated [SAE AMS QQ N 290] brass latch sleeve and mid pieces
Locking system	Push-pull
Keying	Front side: 1 key (alpha=0, female) , Other side: 2 keys (gamma=45, male)
Variant	Watertight / Vacuum-tested unmated (connector to device)
Weight	12.57 g

## Environment

Technical domain	Audio Video, Energy and Industrial, Medical, Semiconductor, Specialties and Other, Test and Measurement, Transportation, Aerospace and UAV
Environmental sealing (IP rating)	Hermetic unmated
Endurance	5000 mating cycles
Temperature range	-20°C / +100°C
Climatical Category	20/80/21
Humidity (max)	<=95% [at 60 deg C /140 F]
Shielding (min)	75 dB (10 MHz)
Shielding (min)	40 dB (1 GHz)
Shock Resistance	100 g [ 6 ms]
Vibration	15 g [10 Hz - 2000 Hz]
Pressure	60 bars
R leak (He) (max)	0.0000001 mbar*l/s (if vacuum-tested)
Salt Spray Corrosion	>1000 hr

## Drawings

[https://www.lemo.com/int\\_en/solutions/originals/b-indoor-keyed/sgj-0b-307-cllpv.html](https://www.lemo.com/int_en/solutions/originals/b-indoor-keyed/sgj-0b-307-cllpv.html)

LEMO products and services are provided "as is". LEMO makes no warranties or representations with regard to LEMO product & services or use of them, express, implied or statutory, including for accuracy, completeness, or security. The user is fully responsible for his products and applications using LEMO components.

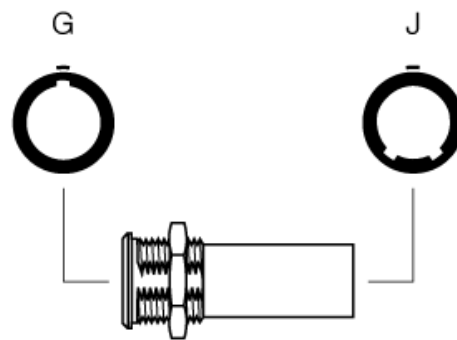
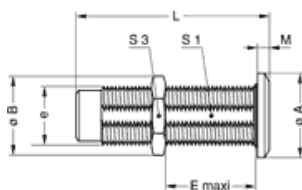

## Dimensions

	<b>A</b>	<b>B</b>	<b>e</b>	<b>E</b>	<b>L</b>	<b>M</b>	<b>S1</b>	<b>S3</b>
mm.	14	13.8	M10x0.75	17	34	2	9	12
in.	0.55	0.54		0.67	1.34	0.08	0.35	0.47

[https://www.lemo.com/int\\_en/solutions/originals/b-indoor-keyed/sgj-0b-307-cllpv.html](https://www.lemo.com/int_en/solutions/originals/b-indoor-keyed/sgj-0b-307-cllpv.html)

LEMO products and services are provided "as is". LEMO makes no warranties or representations with regard to LEMO product & services or use of them, express, implied or statutory, including for accuracy, completeness, or security. The user is fully responsible for his products and applications using LEMO components.