

1

2

3

4

5

6

7

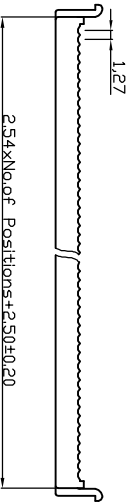
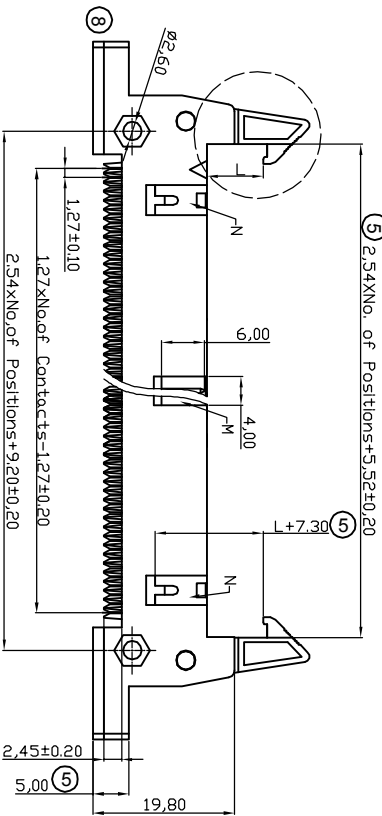
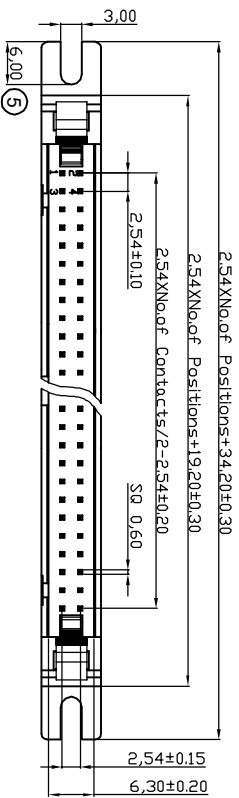

- NOTES:**
- MATERIAL**
1. Insulator Material: PBT+30%G.F. (UL94V-0); Grey
 2. Contact Material: Brass
 3. Contact Plating : 1u" Au selective Over Ni ELECTRICAL
 1. Current Rating : 3.0 AMP
 2. Withstand Voltage : 1000V AC/minute
 3. Contact Resistance : 20mΩ max
 4. Insulation Resistance: 1000MΩ min
- ENVIRONMENTAL**
1. Operation Temperature: -40°C to +105°C
 2. Packing : Tube
 3. 10P~18P with slot "M" without slot "N"
 - 20P~64P with slot "W" and "N"

Ordering Information
AWH XXG-E2X2-IDC

No. of Contacts:
 10-14, 18, 20, 26
 30, 34, 40, 50, 60, 64

Latch Type
 0 - without latch
 2 - with short latches
 3 - with long latches

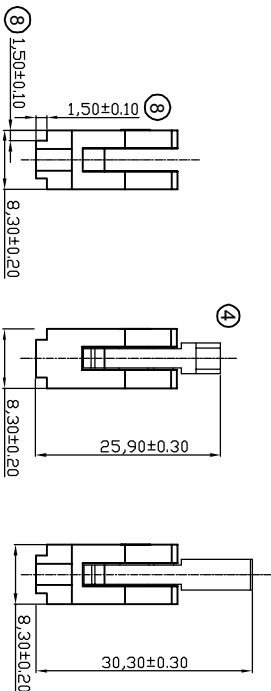

Short Latch

Long Latch

A

B

C

D

E

F

G

H

RoHS compliant
 Unit: mm



Scale	Free	⑨	Correct the dimension L =4.10mm	20.12.2017	Winnie	Date	Name	Customer-No.
TOLERANCE		③	Modify the shape of insulator	05.06.2017	Winnie	29.05.2006	Helwig	ASSMANN WSW-No. AWH XXG-E2X2-IDC
X.X	±0.40	⑦	Change the packing tray into tube	21.09.2015	Winnie	20.19.2017	Winnie	
X.XX	±0.25	⑥	Add UL file no.	12.12.2013	Amy			
X.XXX	±0.15	⑤	Update	03.04.2013	Winnie			
ANGLE	±3°	④	Correct drawing of short latch	05.05.2010	Dean			
DIM	TOL	Id.	Modification	Date	Name			Drawing-No. ASS 0532 CO
								Replace rev09
								Sheet



1

2

3

4

5

6

7

H

G

F

E

D

C

B

A