

THIS DOCUMENT IS THE PROPERTY OF KEYSTONE ELECTRONICS CORP. AND SHALL NOT BE REPRODUCED, DISTRIBUTED OR USED AS A BASIS FOR MANUFACTURE WITHOUT PRIOR WRITTEN PERMISSION FROM KEYSTONE ELECTRONICS CORP.

**PC BOARD PATTERN**

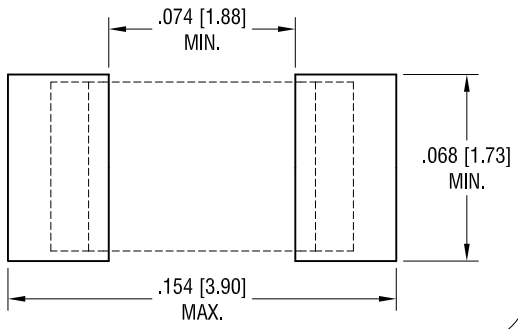

**ACTUAL SIZE**

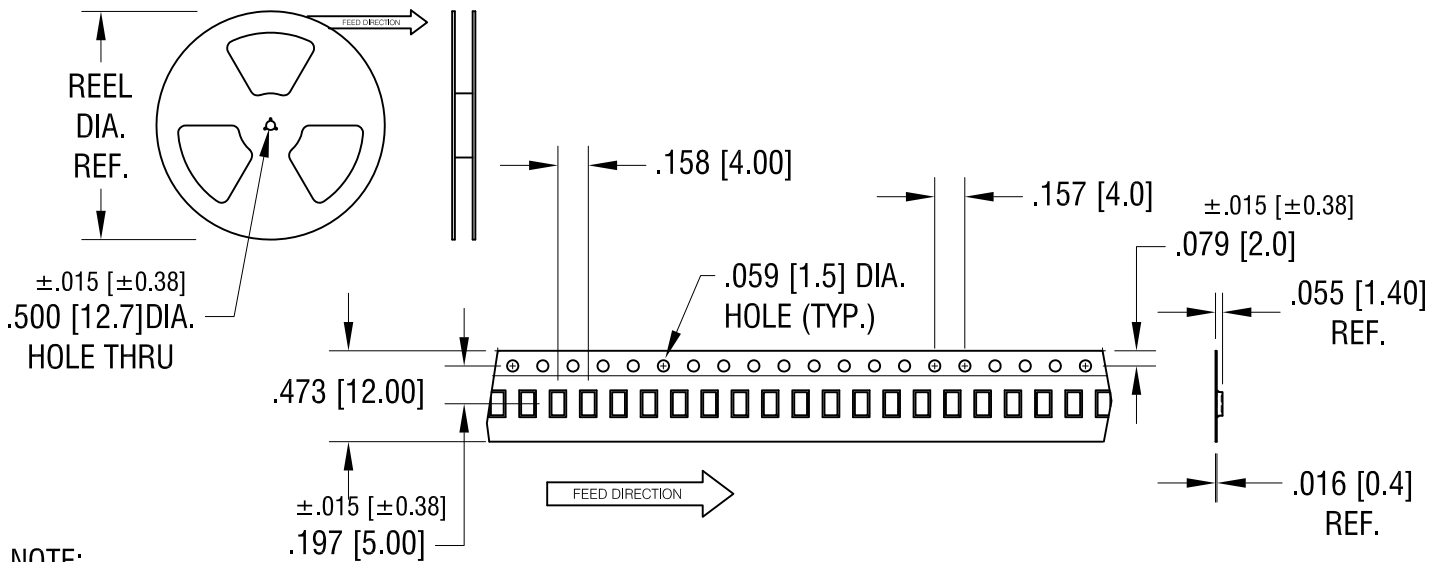
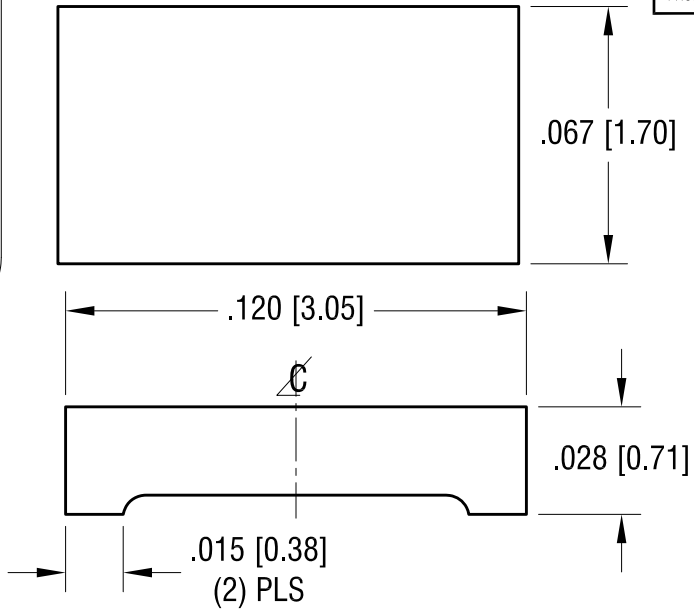

**NOTE:**

**TAPE AND REEL SPECIFICATIONS:**

1. TAPE:  
MAT'L - ALL CONDUCTIVE POLYSTYRENE CARRIER  
ANSI/EIA-481 STANDARD
2. REEL:  
7.00 [178.0] DIA. , 1000 PIECES PER REEL

**PART SPECIFICATIONS:**

1. MAT'L- .028 [0.70] TH'K COPPER  
FINISH: SILVER PLATE

|          |                          |      |
|----------|--------------------------|------|
| 10.01.15 | CHANGE AS PER ECN 15-110 | A    |
| DATE     | DESCRIPTION              | REV. |

|  |                 |              |                 |
|--|-----------------|--------------|-----------------|
| <b>KEYSTONE ELECTRONICS CORP.</b>                              |                 |              |                 |
| www.keyelco.com • NEW HYDE PARK, NY 11040 • Tel (516) 328-7500 |                 |              |                 |
| PART NAME<br>1206 JUMPER ON TAPE AND REEL                      |                 |              |                 |
| MATERIAL<br>AS NOTED   |                 |              |                 |
| FINISH<br>AS NOTED   |                 | DRN BY<br>NT | DATE<br>8.01.14 |
|  |                 | APP'D<br>LN  | SCALE<br>1X,20X |
| TOLERANCES   | INCH [MM]       | CODE         | DWG NO.         |
| DECIMAL  | ± .005 [± 0.13] | C            | 5108            |
| ANGULAR  | ± 1°            |              |                 |
| UNLESS OTHERWISE SPECIFIED                                     |                 |              |                 |